

# \$129,900 - 573 461032 Hwy 13, Rural Wetaskiwin County

MLS® #E4439767

**\$129,900**

0 Bedroom, 0.00 Bathroom,  
Rural on 0.45 Acres

Sunset Bay\_CWET, Rural Wetaskiwin County,  
AB

Immerse yourself in nature with wildlife at your door! Incredible .45 acre parcel of land to build your summer cottage getaway, a year round home, or park a trailer for the summer! Enjoy the peace and quiet away from the big cities, but it is only 90 minutes away from Edmonton, or 3 hours to Calgary.

## Essential Information

MLS® #	E4439767
Price	\$129,900
Bathrooms	0.00
Acres	0.45
Type	Rural
Sub-Type	Vacant Lot/Land
Status	Active

## Community Information

Address	573 461032 Hwy 13
Area	Rural Wetaskiwin County
Subdivision	Sunset Bay_CWET
City	Rural Wetaskiwin County
County	ALBERTA
Province	AB
Postal Code	T0C 0T0

## Exterior

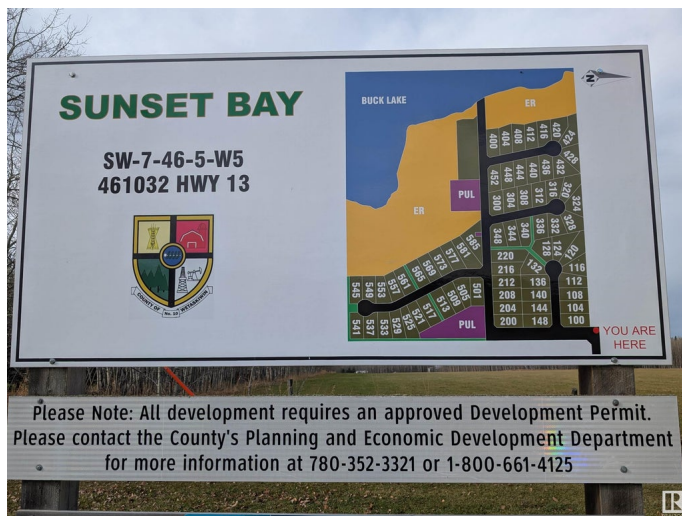

Exterior Features    Beach Access, Boating, Environmental Reserve, Flat Site, Golf Nearby, Lake View, Park/Reserve, Picnic Area, Playground Nearby, Private Setting

**Additional Information**

Date Listed            May 30th, 2025  
Days on Market       34  
Zoning                  Zone 96

DATA IS DEEMED RELIABLE BUT IS NOT GUARANTEED ACCURATE BY THE REALTORS® ASSOCIATION OF EDMONTON. COPYRIGHT 2025 BY THE REALTORS® ASSOCIATION OF EDMONTON. ALL RIGHTS RESERVED.Trademarks are owned or controlled by the Canadian Real Estate Association (CREA) and identify real estate professionals who are members of CREA (REALTOR®, REALTORS®) and/or the quality of services they provide (MLS®, Multiple Listing Service®)  
Listing information last updated on July 3rd, 2025 at 12:47am MDT